

REVISED ASSEMBLY INSTRUCTIONS

ELC ISLAND KITCHEN

ITEM#53109

Please discard any other instructions enclosed

Imported by: Early Learning Centre
Swindon
SN3 4TJ
England



Please retain this information for future reference.

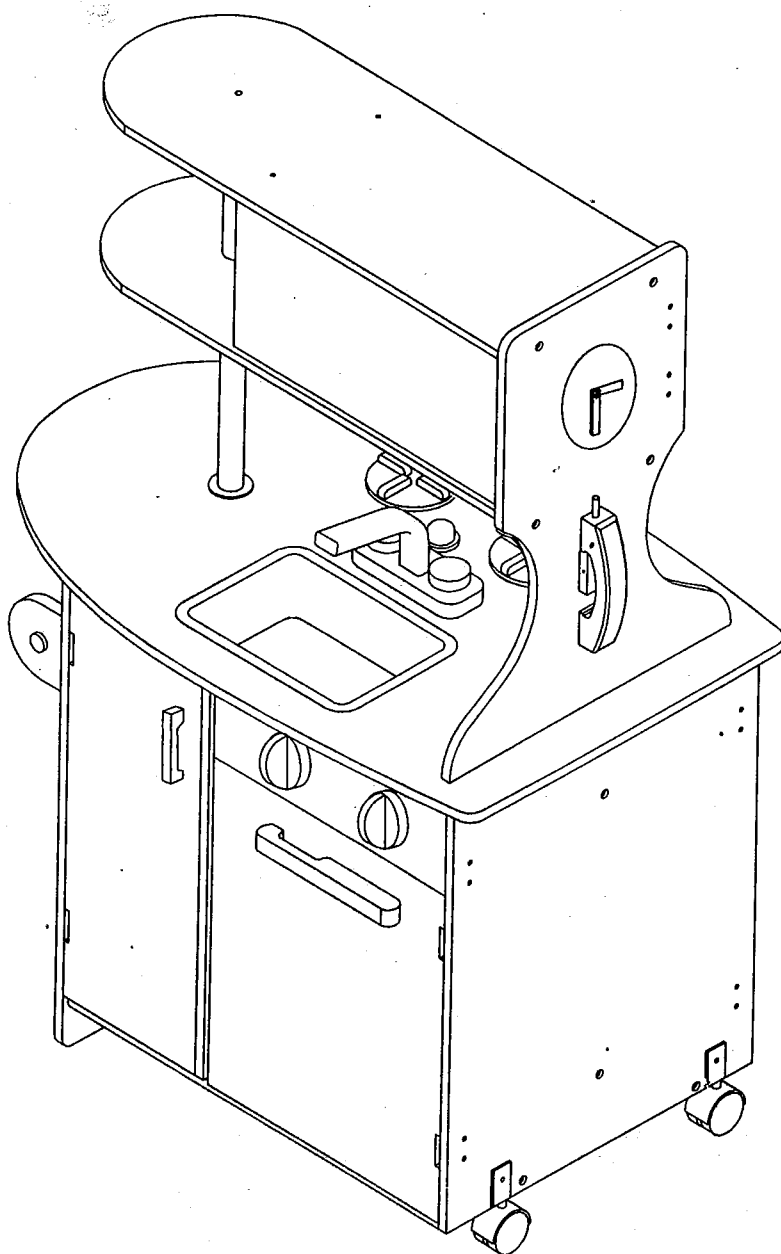

Island Kitchen

Assembly Instructions

Imported by: Early Learning Centre
Swindon
SN3 4TJ
England



ITEM#53109

Please retain this information for future reference.

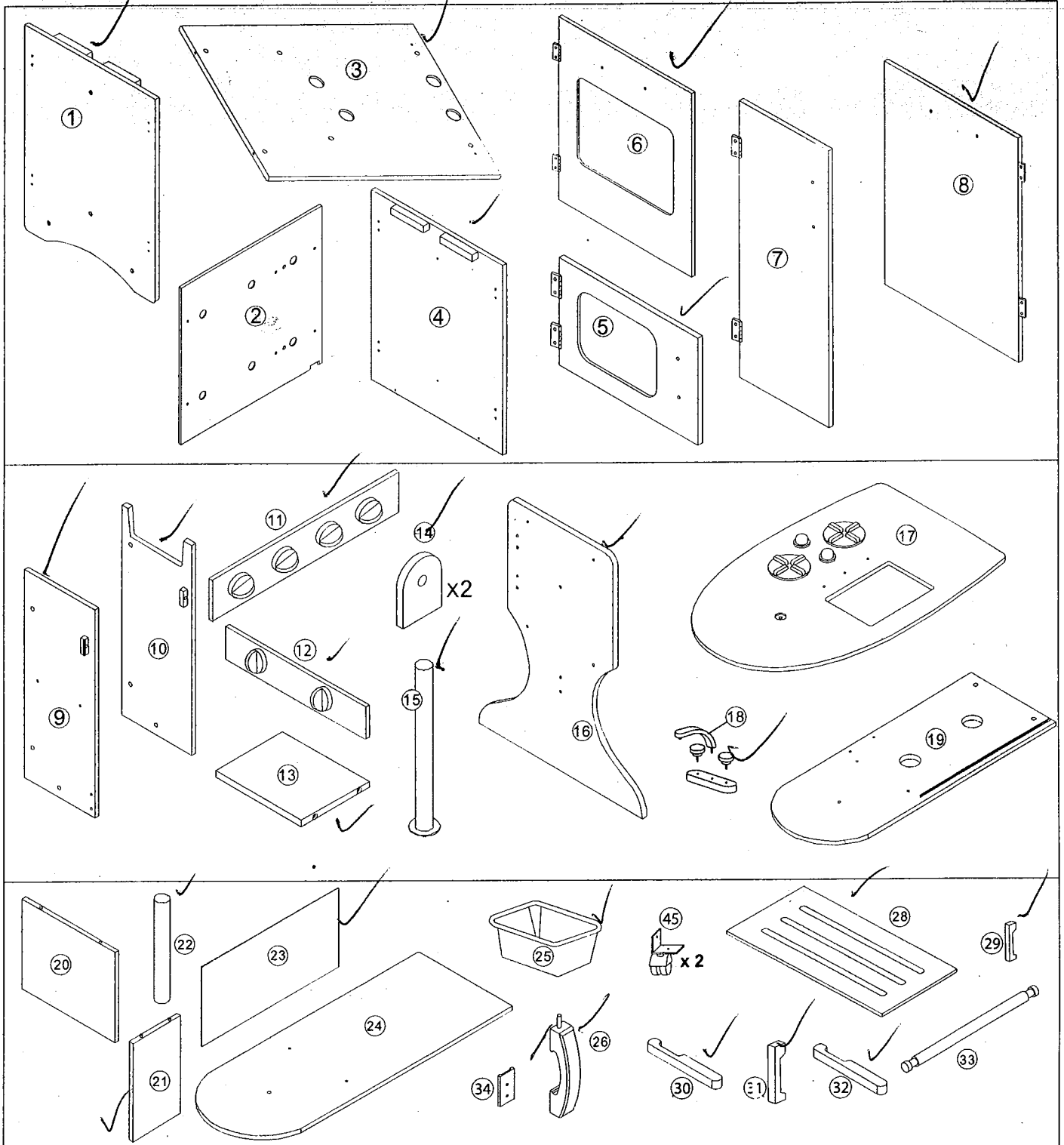

! **CAUTION:** Adult assembly required. Hardware contains small screws with sharp points. Keep unassembled parts out of the reach of small children.

USE AND MAINTENANCE:
-Use on level surfaces only
-Please check assembly at regular intervals, and periodically tighten hardware of necessary. If maintenance is not carried out the product could over turn or fall

! **WARNING: CHOKING HAZARD**
Unassembled parts may be a choking hazard to children 3 years of age and younger.

Island Kitchen

Assembly Instructions

Imported by: Early Learning Centre
Swindon
SN3 4TJ
England



ITEM#53109

Please retain this information for future reference.

HARDWARE		Step 1
A. Pink Cross Dowel Bolt x 18 pcs (48mm x 6mm)	I. Screw x 5 pcs (14.5mm)	
A1. Cross Dowel Nut x 18 pcs	J. Pink Cap Nut Bolt x 20 pcs	
B. Pink Cross Dowel Bolt x 8 pcs (50mm x 4mm)	K. Hex Bolt x 2 pcs (47mm)	
B1. Cross Dowel Nut x 12 pcs	L. Small Washer x 3 pcs	
B2. Gold Cross Dowel Bolt x 4 pcs (50mm x 4mm)	M. Clock Hand x 1 pc	
C. Gold Cross Dowel Bolt x 2 pcs (48mm x 6mm)	N. Medium Washer x 3 pcs	
D. Gold Screw x 16 pcs (22mm)	O. Hex Bolt x 1 pc (28mm x 6mm)	
E. Pink Screw x 8 pcs (22mm)	P. Large Washer x 1 pc	
F. Flat Bolt x 18 pcs (19mm)	Q. Nylon Nut x 1 pc	
G. Pan Head Bolt x 2 pcs (25mm)	Allen Wrench x 1 pc	
H. Bolt x 1 pc (50mm)	Wrench x 1 pcs	
	The following tool is required for assembly: Phillips® screwdriver	

IMPORTANT! DO NOT TIGHTEN SCREWS OR BOLTS UNTIL COMPLETELY ASSEMBLED.

Island Kitchen

Assembly Instructions

ITEM#53109

Imported by: Early Learning Centre
Swindon
SN3 4TJ
England



Please retain this information for future reference.

Step 3

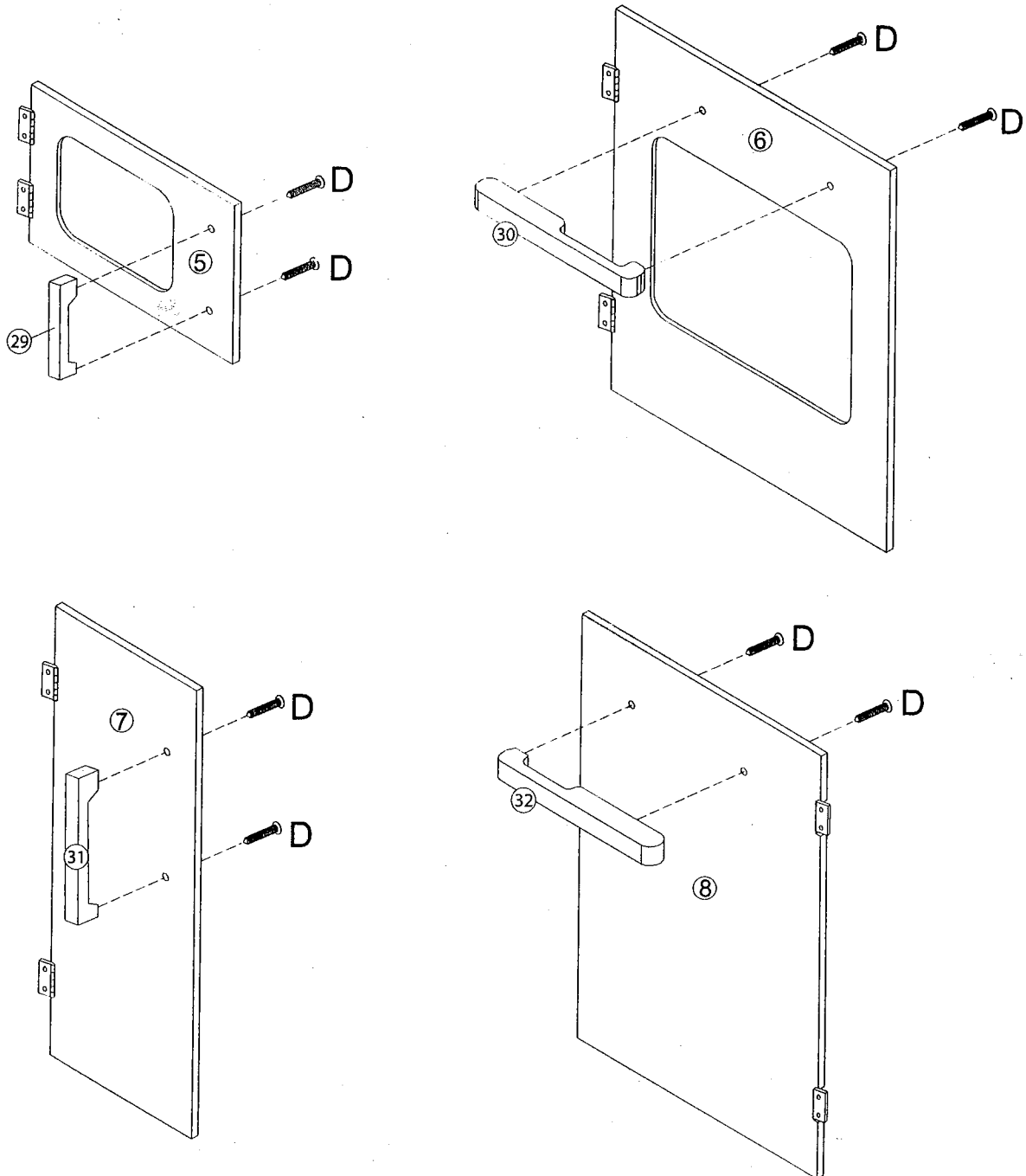

Island Kitchen

Assembly Instructions

ITEM#53109

Imported by: Early Learning Centre
Swindon
SN3 4TJ
England



Please retain this information for future reference.

Step 4

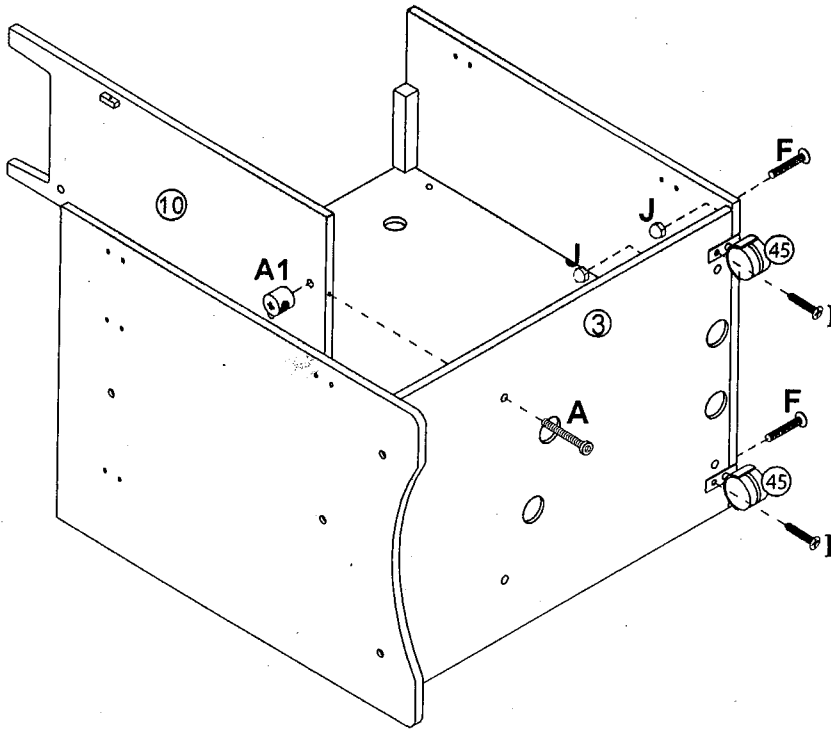

Step 5

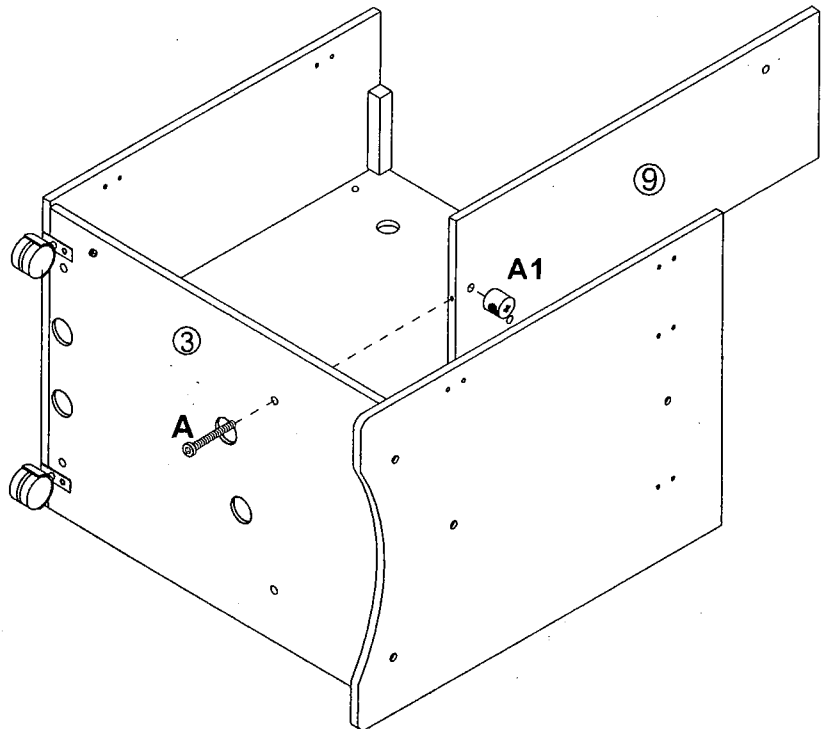

Island Kitchen

Assembly Instructions

ITEM#53109

Imported by: Early Learning Centre
Swindon
SN3 4TJ
England



Please retain this information for future reference.

Step 6

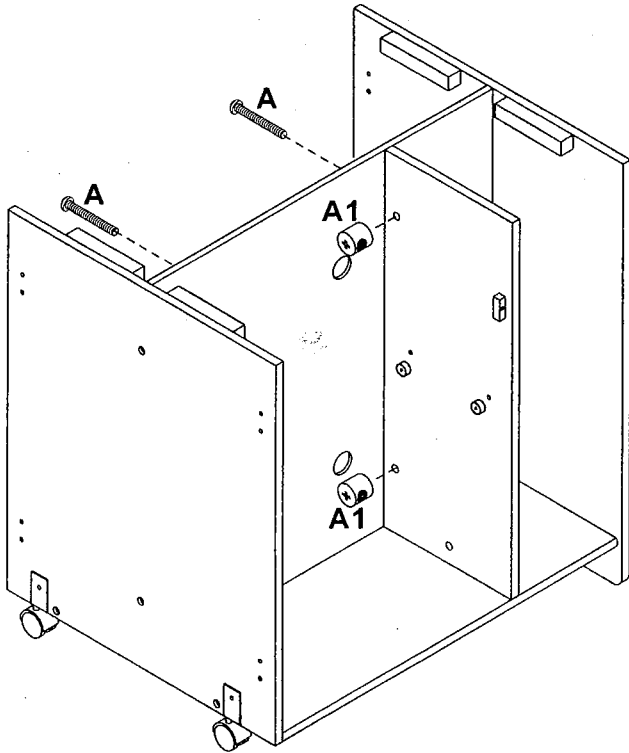

Step 7

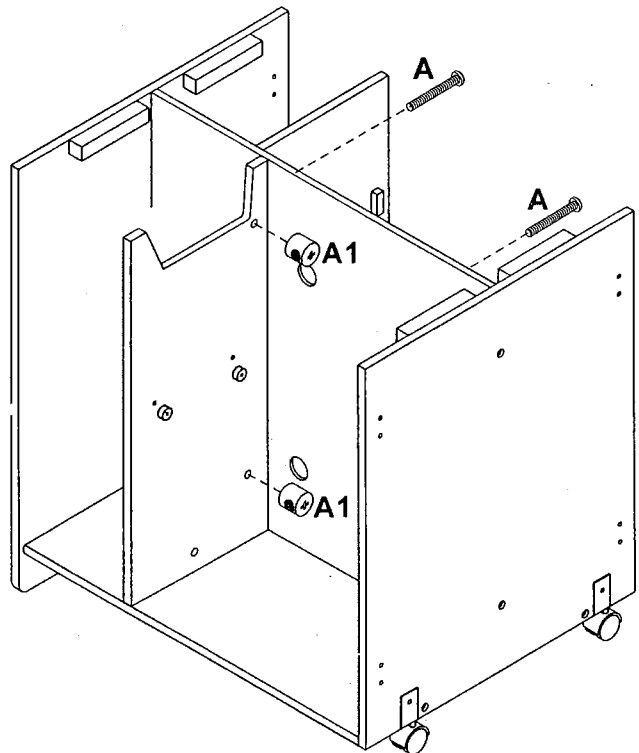

Island Kitchen

Assembly Instructions

ITEM#53109

Imported by: Early Learning Centre
Swindon
SN3 4TJ
England



Please retain this information for future reference.

Step 8

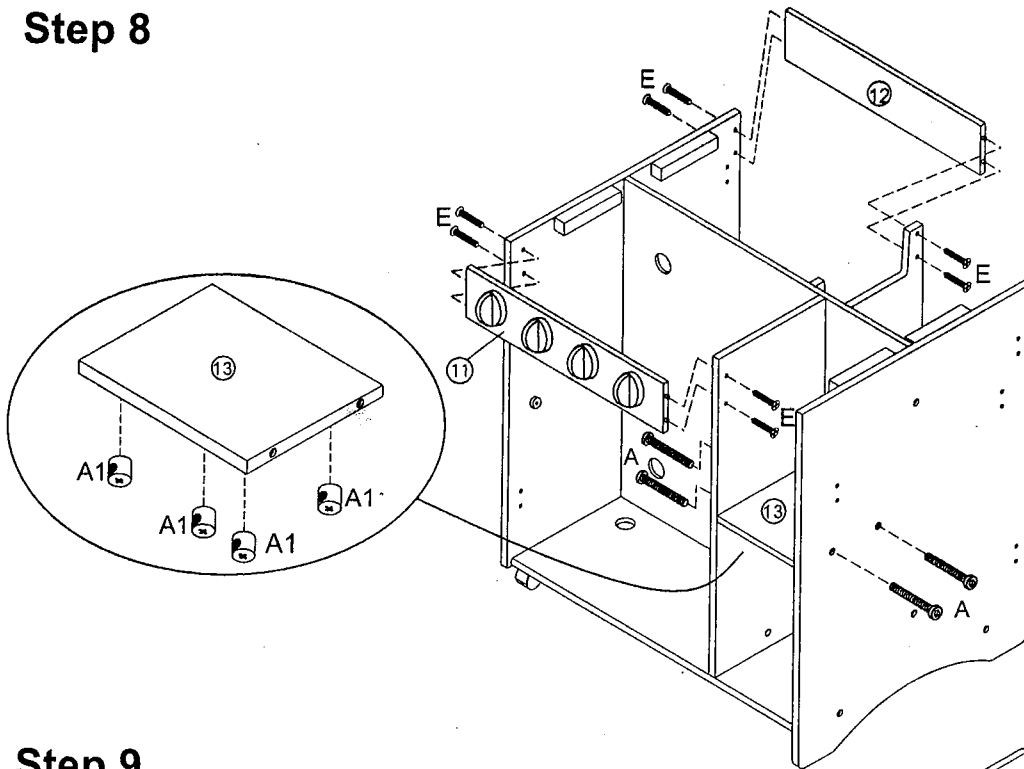

Step 9

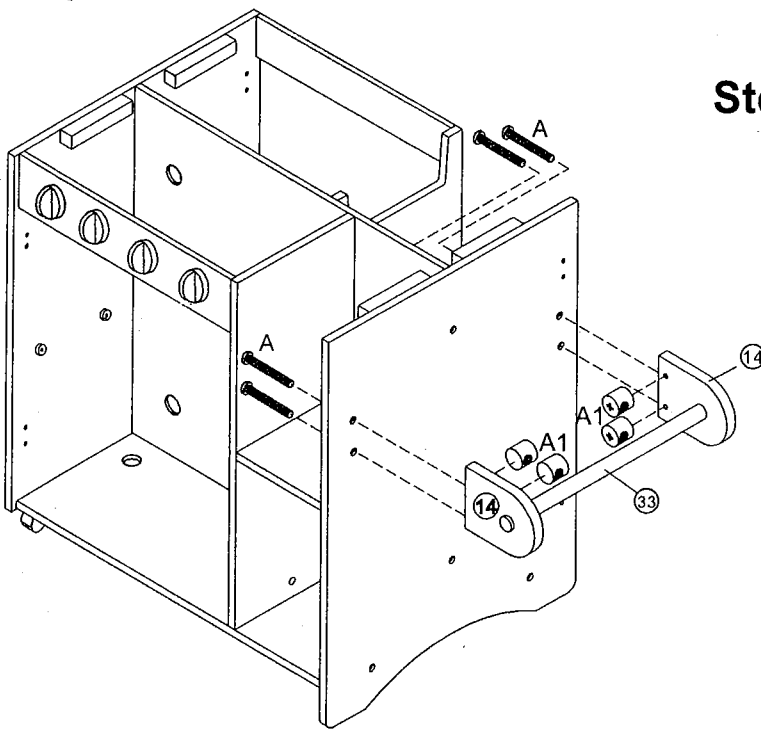

Step 10

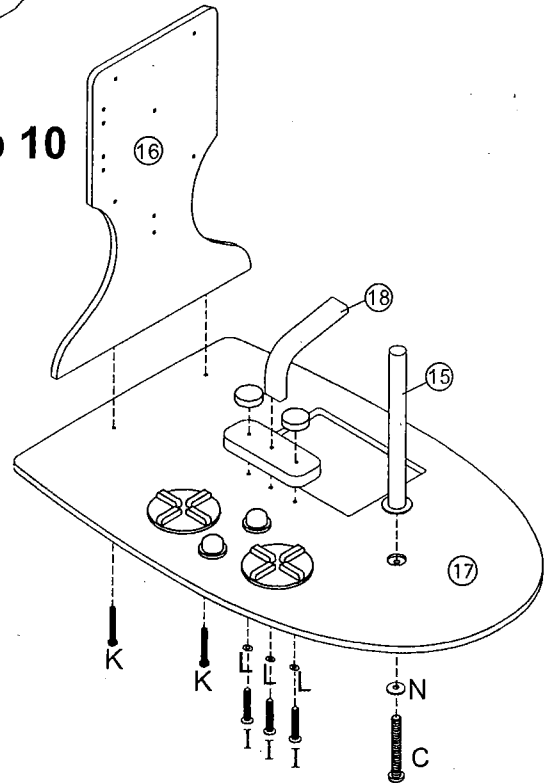

Island Kitchen

Assembly Instructions

ITEM#53109

Imported by: Early Learning Centre
Swindon
SN3 4TJ
England



Please retain this information for future reference.

Step 11

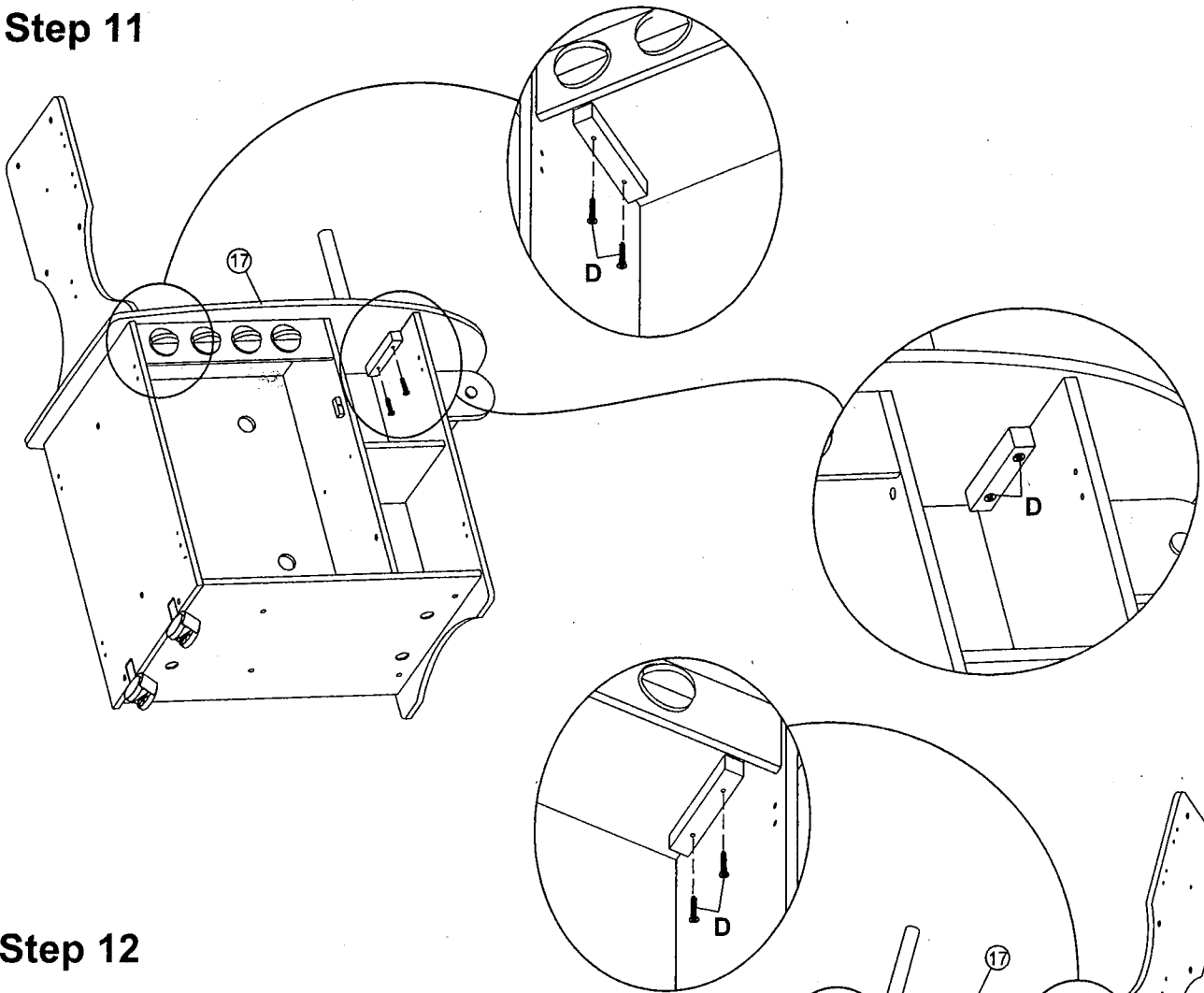

Step 12

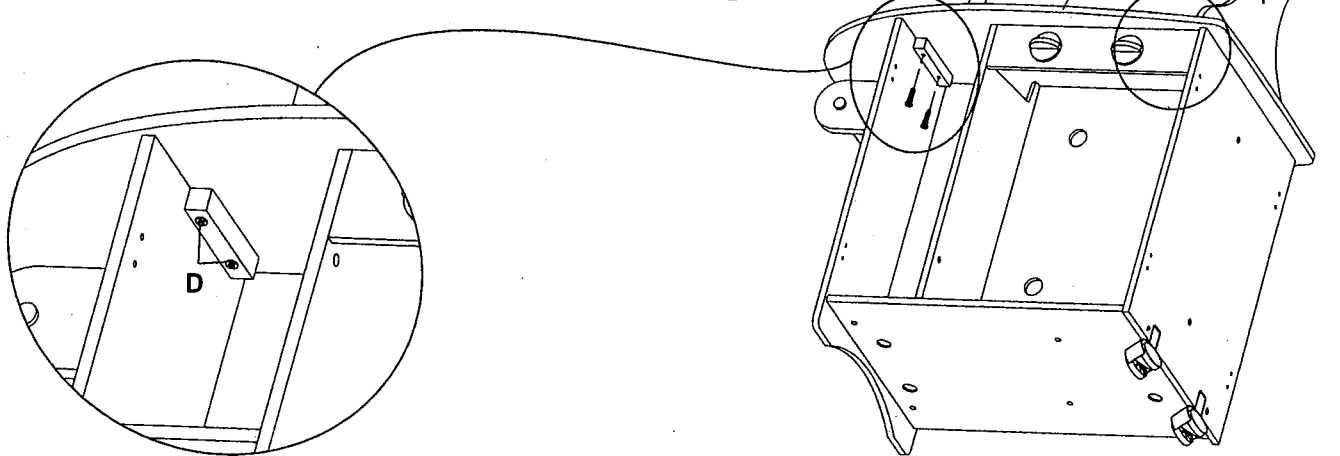

Island Kitchen

Assembly Instructions

ITEM#53109

Imported by: Early Learning Centre
Swindon
SN3 4TJ
England



Please retain this information for future reference.

Step 13

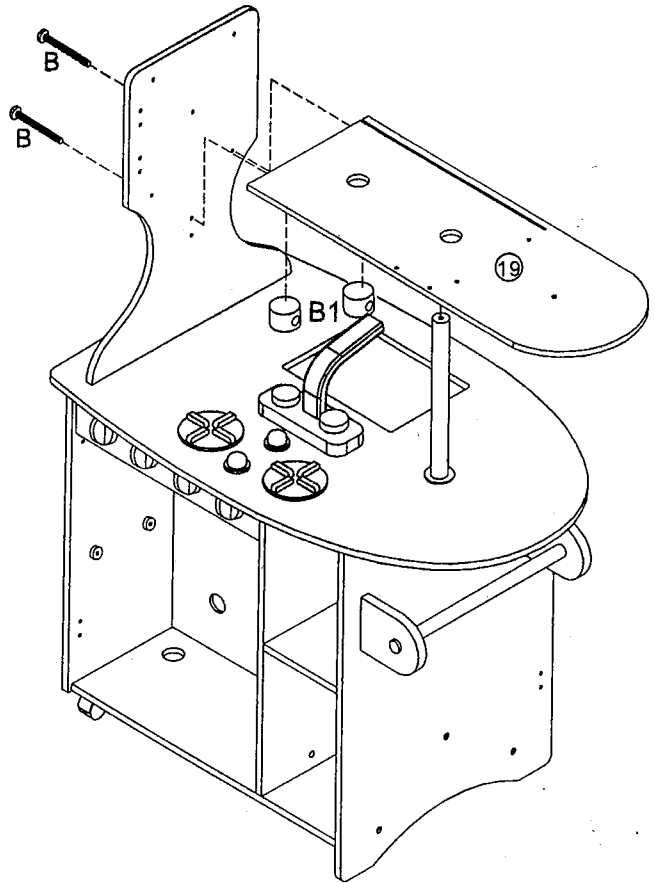

Step 14

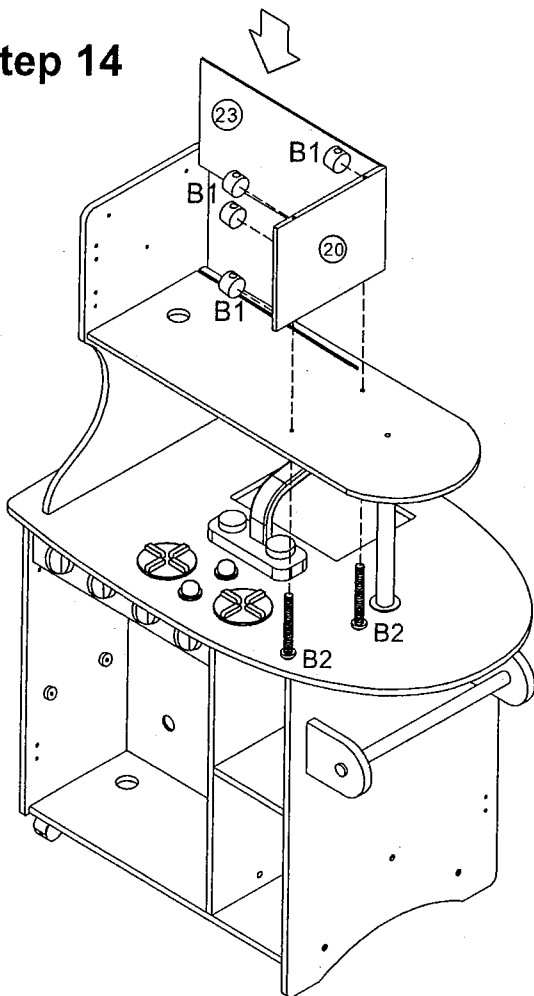

Island Kitchen

Assembly Instructions

ITEM#53109

Imported by: Early Learning Centre
Swindon
SN3 4TJ
England



Please retain this information for future reference.

Step 15

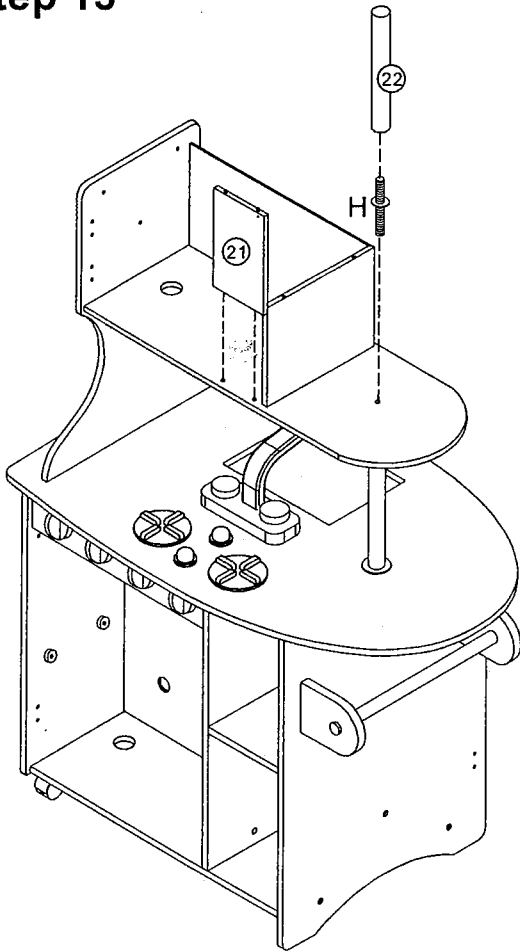

Step 16

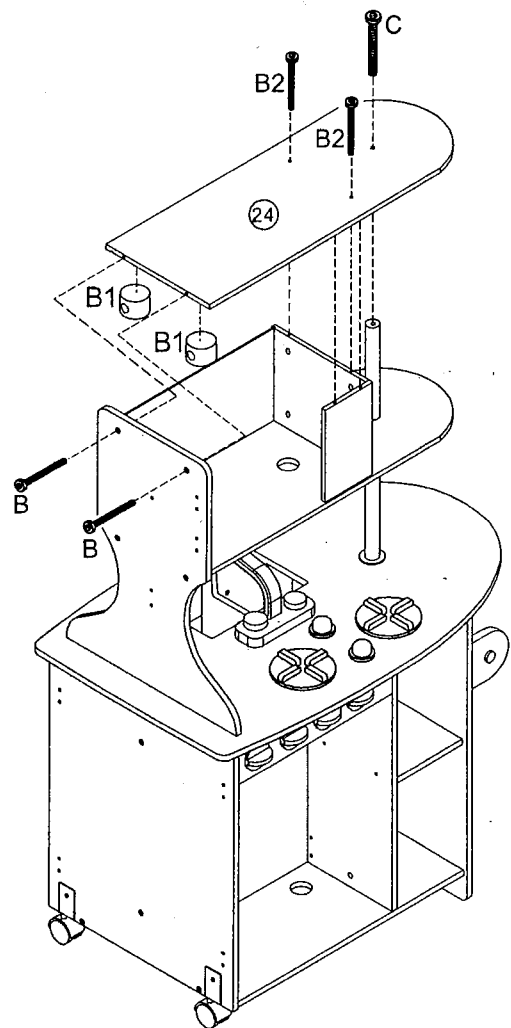

Island Kitchen

Assembly Instructions

ITEM#53109

Imported by: Early Learning Centre
Swindon
SN3 4TJ
England



Please retain this information for future reference.

Step 17

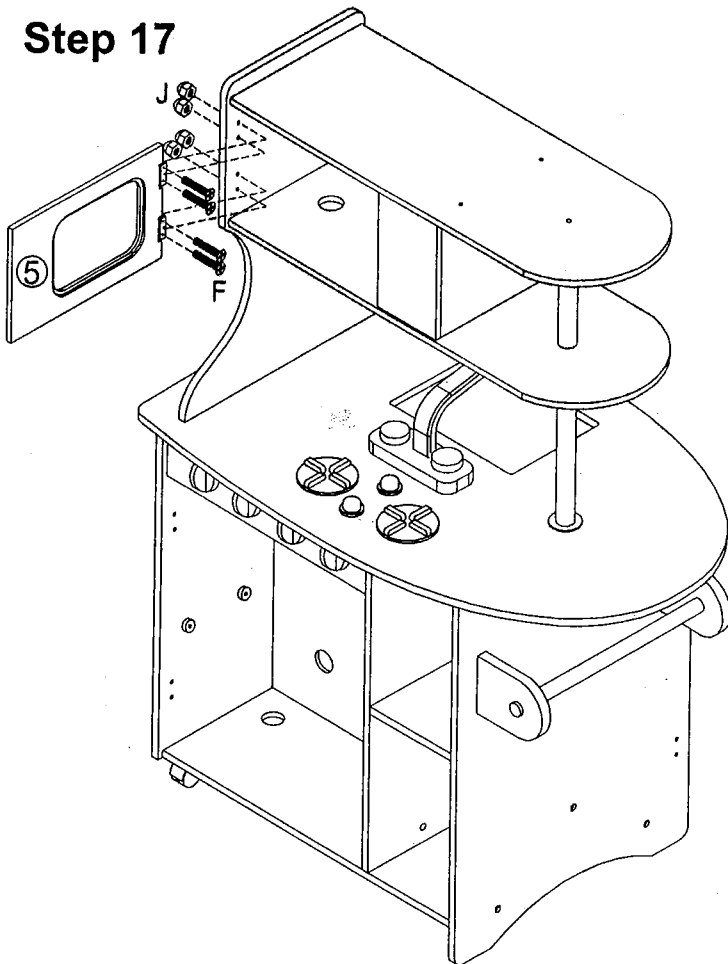

Step 18

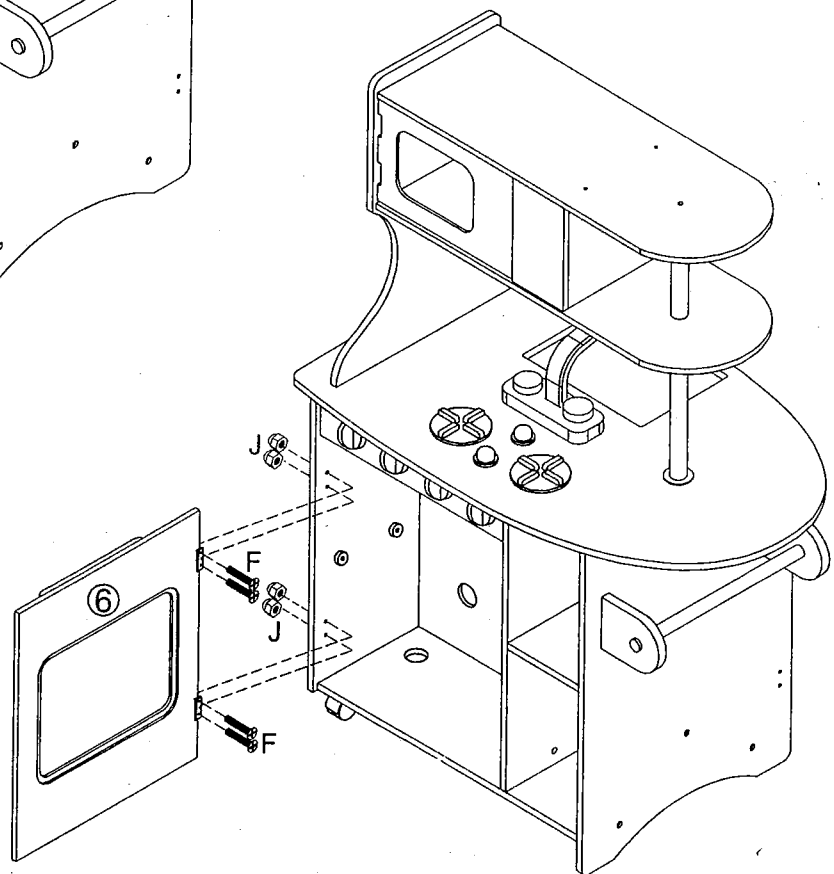

Island Kitchen

Assembly Instructions

ITEM#53109

Imported by: Early Learning Centre
Swindon
SN3 4TJ
England



Please retain this information for future reference.

Step 19

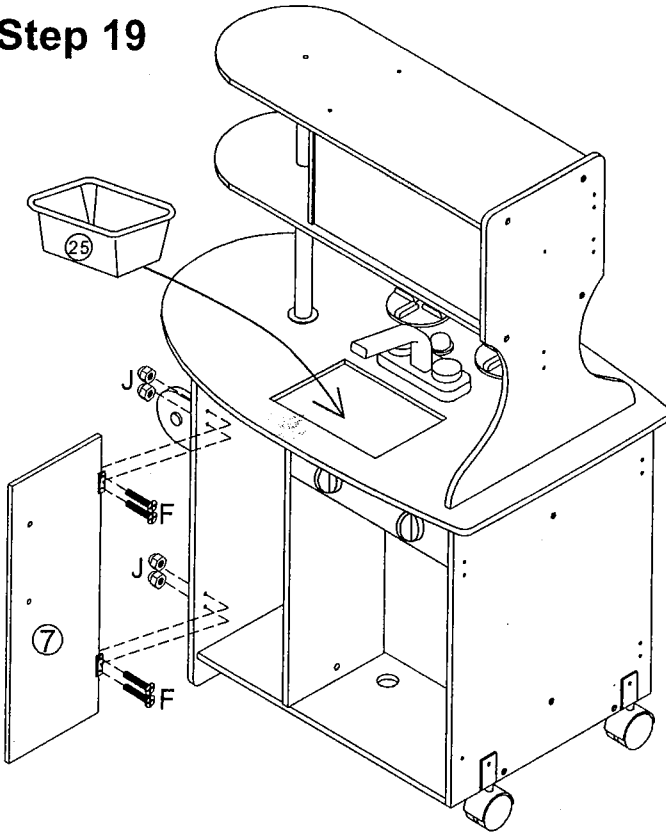

Step 20

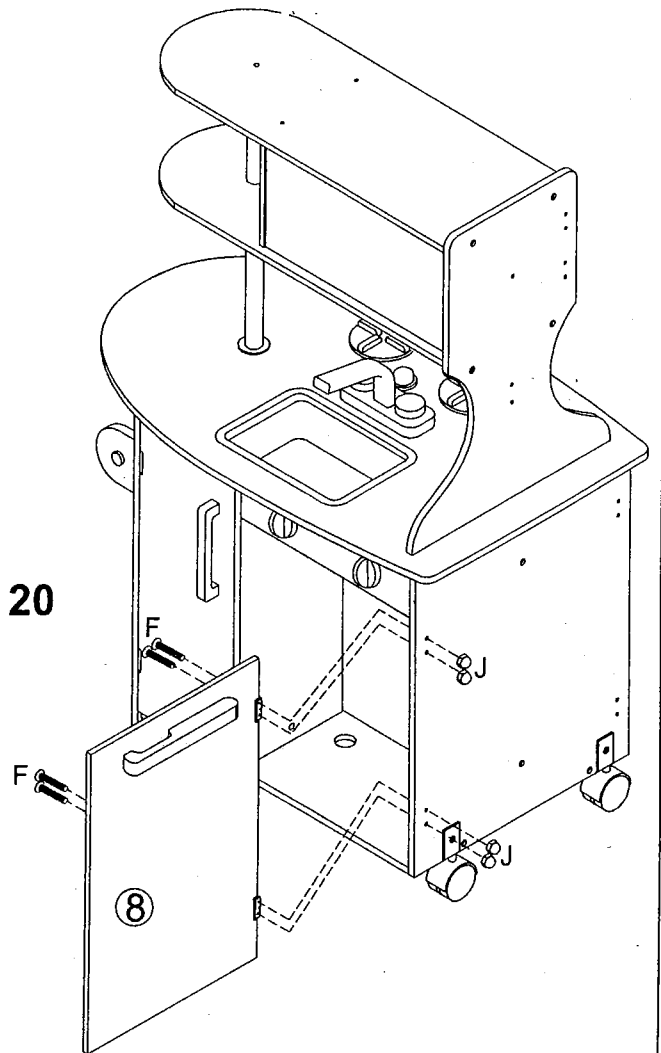

Island Kitchen

Assembly Instructions

ITEM#53109

Imported by: Early Learning Centre
Swindon
SN3 4TJ
England



Please retain this information for future reference.

Step 21

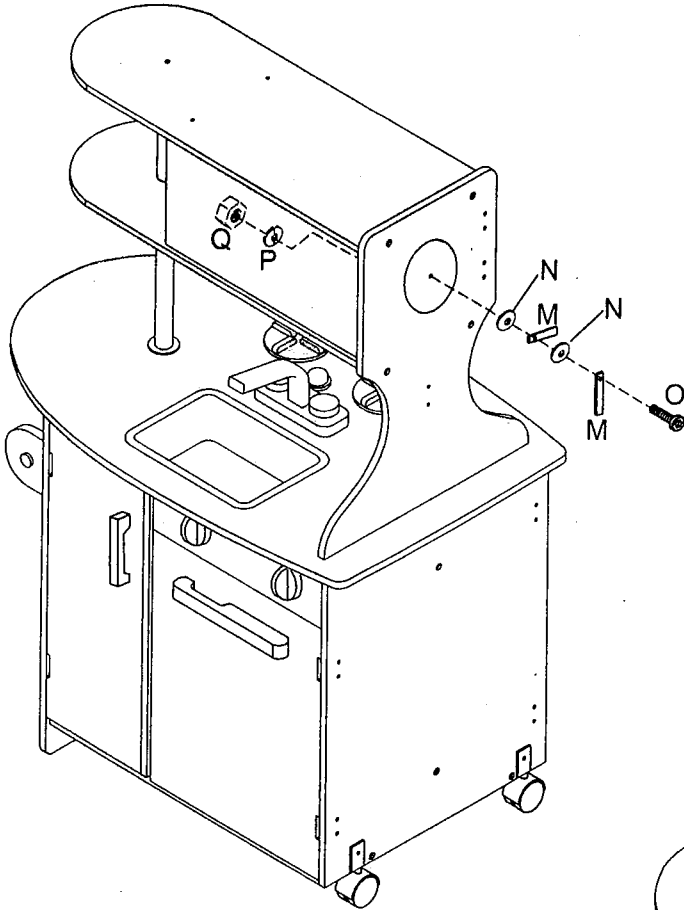

Step 22

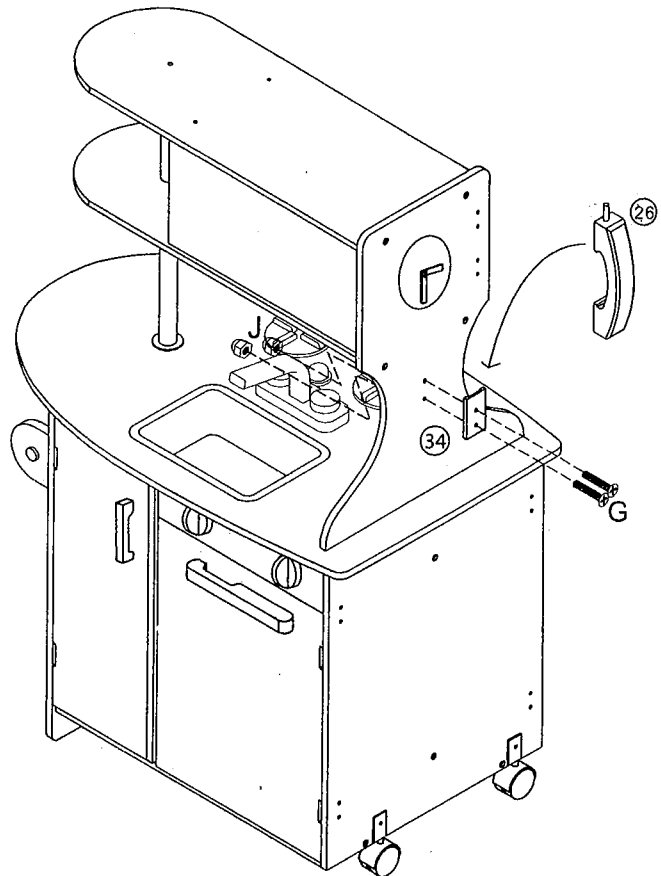

Island Kitchen

Assembly Instructions

ITEM#53109

Imported by: Early Learning Centre
Swindon
SN3 4TJ
England



Please retain this information for future reference.

Step 23

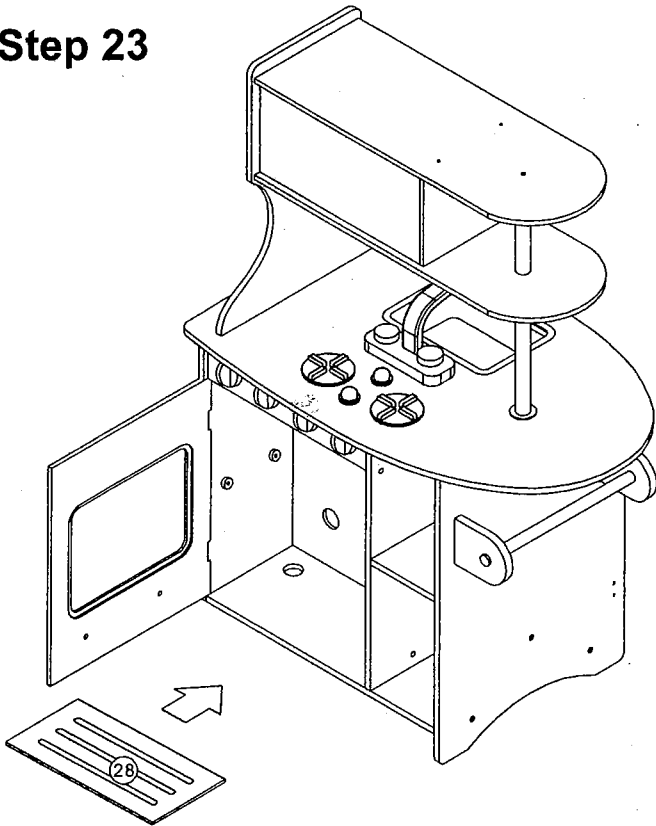

Complete

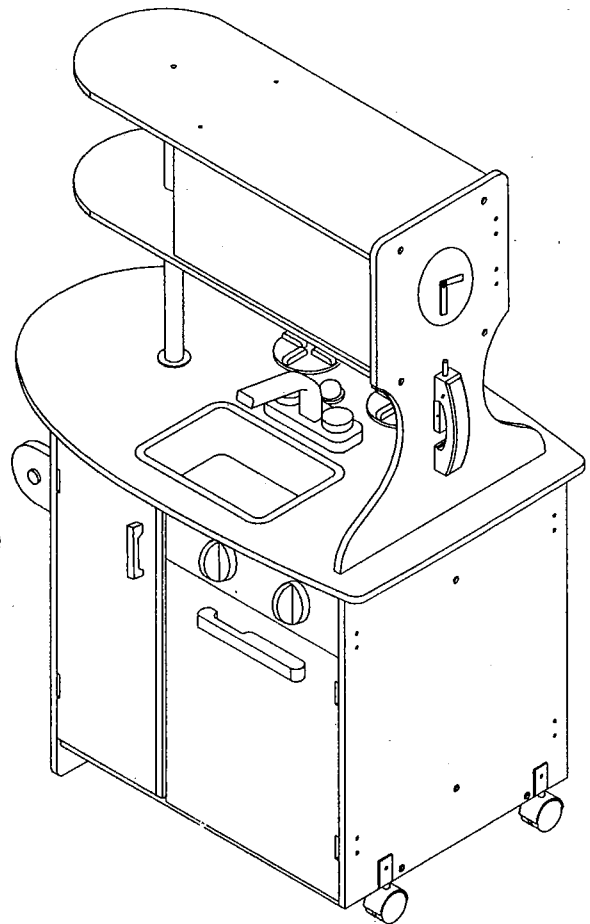

**Imported by: Early Learning Centre
Swindon
SN3 4TJ
England**



Please retain this information for future reference.

IMPORTANT INFORMATION - PLEASE READ FIRST

ALL OF OUR WOODEN ITEMS ARE HANDCRAFTED, HAND ASSEMBLED, AND HAND PAINTED. EACH ONE IS UNIQUE. SLIGHT IMPERFECTIONS MAY OCCUR AND ARE NOT MANUFACTURING DEFECTS. EACH ITEM HAS BEEN PAINTED WITH A VERY DURABLE PAINT THAT IS BOTH LEAD AND CHROMATE FREE AND SAFE FOR CHILDREN. HOWEVER, IT WILL NOT WITHSTAND ABNORMAL ABUSE AND WITH IMPROPER USE IT COULD CHIP. TOUCH-UP PAINTS ARE AVAILABLE FOR A NOMINAL CHARGE IF NEEDED. PLEASE CONTACT US DIRECTLY AND WE WILL FORWARD YOU THE NECESSARY COLOR.

PLEASE NOTE THAT WE DO NOT WARRANTY AGAINST THE USE OF PERMANENT MARKERS, NON-WATER-BASED PAINTS, CRAYONS, OR WASHABLE MARKERS. SOME OF THESE ITEMS CONTAIN PERMANENT COLOR DYES THAT COULD DAMAGE THE SURFACE.

CLEANING INSTRUCTIONS

CLEAN THE SURFACE USING A SLIGHTLY DAMP CLOTH AND MILD DISHWASHING LIQUID IF NECESSARY. DO NOT USE ANY CLEANING PRODUCT CONTAINING ALCOHOL OR AMMONIA. THESE WILL DULL THE SHINY SURFACE OF THE PRODUCT. FURNITURE POLISH WILL ALSO WORK TO CLEAN AND DUST OFF THE SURFACE.

WE RECOMMEND THAT YOU TEST ALL CLEANING MATERIALS ON THE UNDERSIDE OF ANY SURFACE THAT WOULD NOT BE SEEN DURING NORMAL USE OF THE PRODUCT. IF YOU HAVE QUESTIONS REGARDING THE MAINTENANCE OF THIS PRODUCT PLEASE FEEL FREE TO CALL US.

WARRANTY

IMPORTANT: EVIDENCE OF ORIGINAL PURCHASE IS REQUIRED FOR WARRANTY SERVICE.

LENGTH OF WARRANTY: 90 DAYS FROM DATE OF PURCHASE.

THIS WARRANTY COVERS DEFECTS THAT WERE A RESULT OF THE MANUFACTURERS PRODUCTION. YOU SHOULD CAREFULLY INSPECT THE CONDITION OF THE PRODUCT PRIOR TO ASSEMBLY. THIS WARRANTY IS INVALID IF THE PRODUCT IS DAMAGED OR NOT MAINTAINED AS REASONABLE OR NECESSARY.